

ARROWHEAD WOODS PROPERTY BOUNDARY

The Arrowhead Woods was established in 1923

Arrowhead Woods refers to a defined boundary of properties surrounding Lake Arrowhead that carry exclusive private lake rights as governed by the Arrowhead Lake Association.

If a property is located within the dashed boundary, it's eligible for lake access, dock rights, and trail use — Lake Rights not available to properties outside this zone.

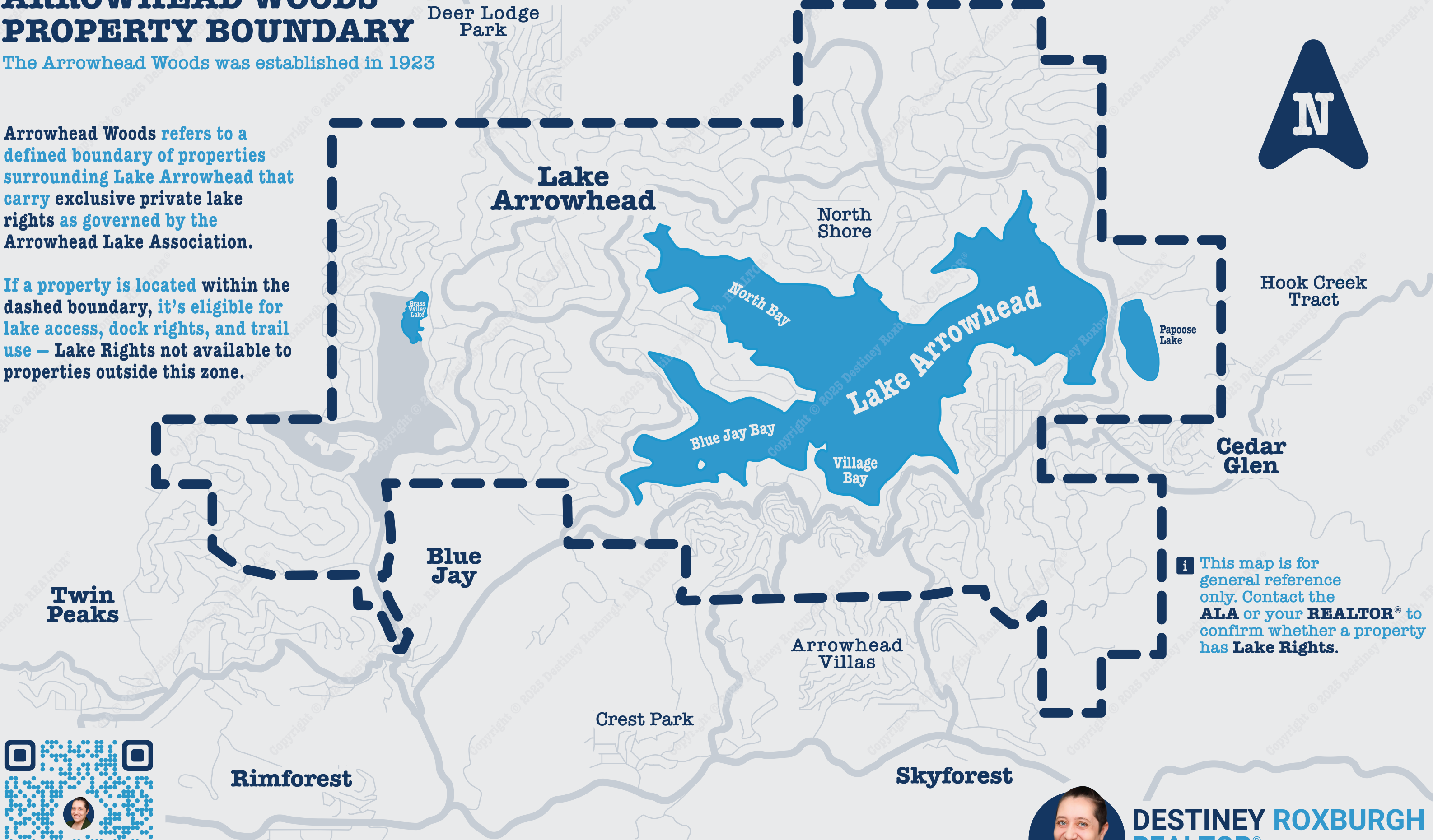

i This map is for general reference only. Contact the **ALA** or your **REALTOR®** to confirm whether a property has **Lake Rights**.

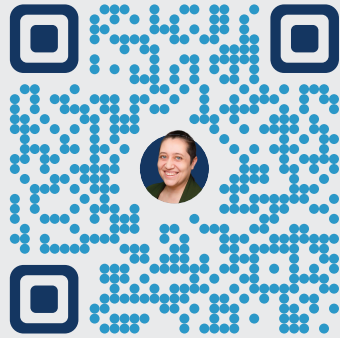

*Last updated July 2025
provided by DestinetyRoxRealEstate.com



DESTINEY ROXBURGH
REALTOR®
DRE# 02231191